



SBL SERIES INSTALLATION GUIDE

Your SBL Series bollard light will arrive with the **"BATTERY DISCONNECTED"**

WHEN PRODUCT ARRIVES

STEP 1

- If the light has arrived pre-assembled remove the 4 x M6 security bolts using the Security Driver bit taped to the pole. Put the light head somewhere safe for later re-attachment.
- If light and poles have arrived separately packed which is common for large volume projects, leave light/s in carton until required.

STEP 2 - INSTALL THE MOUNTING POLE
per pole type installation instructions on next page

AFTER MOUNTING POLE INSTALLED

STEP 3 - RE-ATTACH SBL LIGHT HEAD

1. Connect the weatherproof battery connectors together exactly as shown below with locking lugs on same side to activate power to the unit.

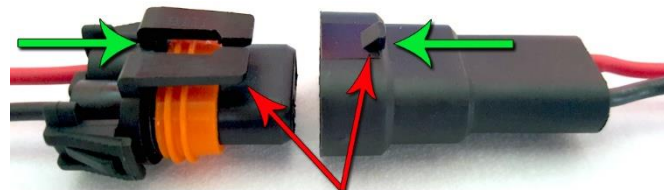

Align Locking Tabs On Connectors and Push Together Securely

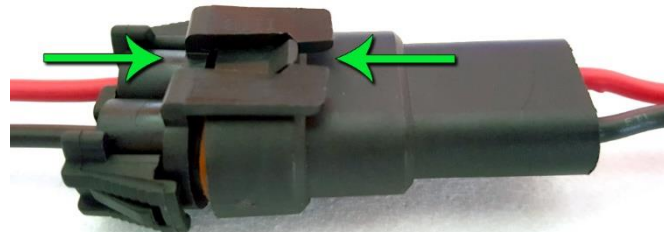

Connecting battery incorrectly will damage the battery.
Handle battery connector cables with care.

Congratulations on purchasing your SBL Series Solar Bollard Light



IMPORTANT BEFORE YOU INSTALL

The standard SBL Series Solar Bollard is designed to be installed in direct uninterrupted sunlight from dawn until dusk based on winter month's sun trajectory/angle.

If shading from trees or other structures are found at the installation site not discussed prior to delivery of your order, please immediately contact your supplier prior to commencing the installation as a different power model may possibly be required just for those shaded areas.

2. Slide light mounting shaft into pole aligning securing points of light and pole until Spun Collar is sitting flush with top of the pole edge.
3. Then pushing down on light head top dome with enough pressure and turning light head if need be until **securing points** line up.

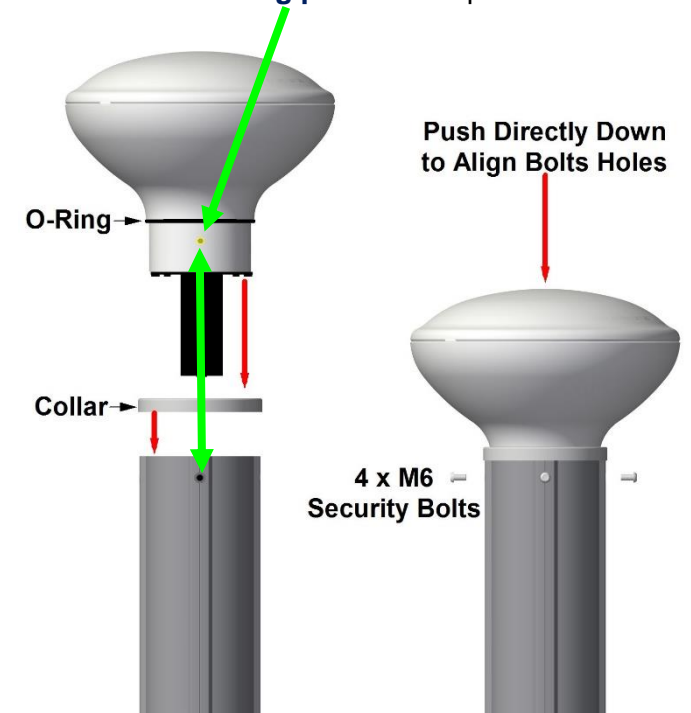

4. Finally install 4 x M6 security bolts supplied with lights by hand initially to ensure no cross threading is occurring, then tighten with cordless ratchet driver using driver tool until firm. **DO NOT** over tighten and strip threads.
5. Your SBL Series Solar Bollard Light is now installed and ready for operation.

SBL SERIES MOUNTING TYPE INSTALLATION INSTRUCTIONS

BURIED IN GROUND POLE

BEFORE YOU INSTALL: Dial before you Dig
Ensure Anchor Bolts are through pole base/s.

STEP 2A - Dig hole to depth for pole length being used as per below instructions:

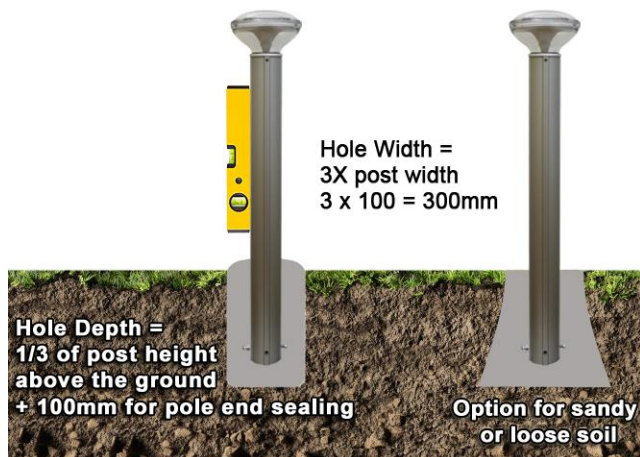

Note: A larger concrete foundation maybe required for very poor (sandy) soil

Pole Length	Hole Depth	Insert Pole	Hole Diameter
1140mm 45'	400mm 16'	300mm 12'	300mm 12'
2840mm 112'	600mm 25'	500mm 20'	300mm 12'
3640mm 143'	900mm 36'	800mm 31'	300mm 12'

STEP 2B - Pour concrete into the hole

STEP 2C - Insert pole into concrete ensuring the internal of the pole is also filled with concrete. Use spirit level to ensure pole is set correctly.

STEP 2D - Cure concrete before re-attaching the SBL Series light head. Cover the pole top with plastic or similar.

RETURN TO PREVIOUS PAGE STEP 3:
Light Head Re-Attachment Instructions

GROUND MOUNT POLE

BEFORE YOU INSTALL: (not included in kit)
Mounting Bolts, M12 (1/2) Washer, 4 x M12 (1/2) Nuts.
We recommend using security fasteners to prevent theft.

STEP 2A - Check with spirit level mounting surface is flat as pole must sit level for solar recharging.

STEP 2B - Mark out holes on mounting surface to suit base plate.

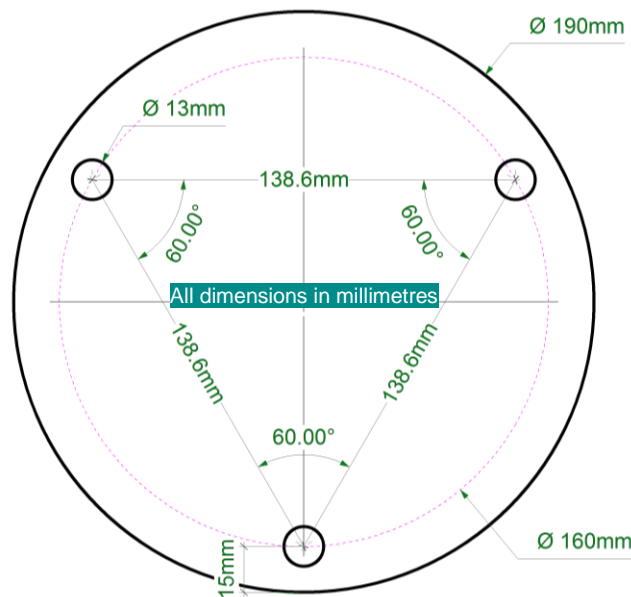

STEP 2C - Drill or core hole to take an M12 (1/2) thread or other securing device

STEP 2D - Install your mounting threads. ENSURE MINIMUM of 30mm (1.2') of actual thread is protruding above surface. Base plate thickness is 12mm (0.5').

STEP 2E - Place the base plate over the bolts and secure pole with your locking nuts. Use spirit level while tensioning to ensure pole is set level.

RETURN TO PREVIOUS PAGE STEP 3:
Light Head Re-Attachment Instructions

WALL MOUNT INSTALLATION

BEFORE YOU INSTALL: (not included in kit)
Mounting Bolts, M12 (1/2) Washer, 4 x M12 (1/2) Nuts.
We recommend using security fasteners to prevent theft.

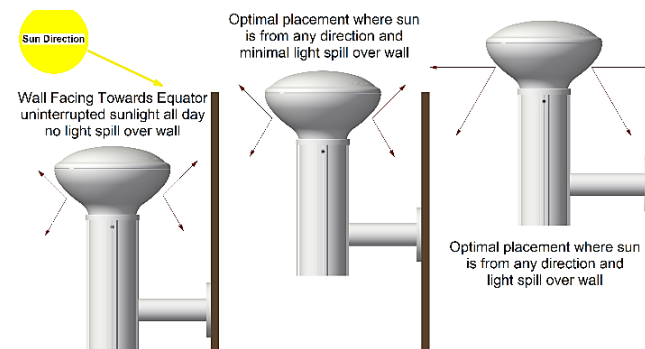

Note: Lower power models can achieve the lower mounting position without full directional sun all day.

STEP 2A - Mark holes on surface to suit wall plate.

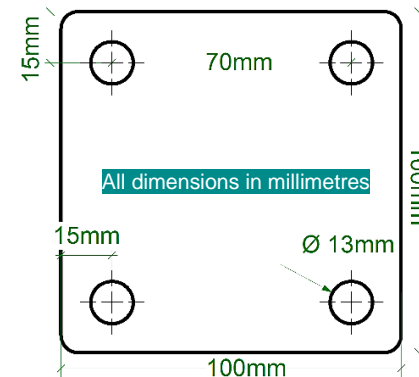

STEP 2B - Drill or core hole to take an M12 (1/2) securing device then install your mounting threads. ENSURE MINIMUM of 30mm (1.2') of actual thread is protruding above concrete. Wall plate thickness 10mm (0.4')

STEP 2C - Place plate over the bolts and secure plate with your locking nuts.

RETURN TO PREVIOUS PAGE STEP 3:
Light Head Re-Attachment Instructions